



GreenSeam Snap Lock Pipe
6EKE9

Self-Sealing Duct & Fittings

- Max. pressure rating: 2 in wc
- Max. temp. rating: 212°F
- Collar with damper has 1" flange outside diameter

GreenSeam Plus Snap-Lock Pipe is self-sealing duct for commercial and residential applications. Engineered with a LEED qualifying zero-VOC gasket; eliminates additional sealing along the longitudinal seams and transverse joint. When used with GSI sealed fittings, GreenSeam Plus system reduces energy costs and increases overall system efficiency. Each box contains five 5-ft. sections (25-ft. total).

Note: Call 1-800-GRAINGER (472-4643) for specialty ordering information.

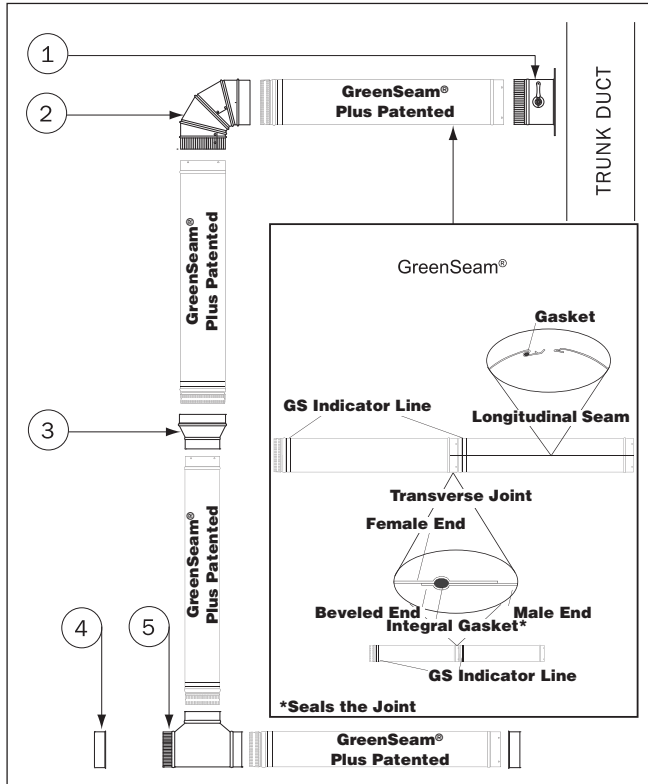

For Duct Dia. (in)	Overall Length (in)	Overall Height (in)	26 ga Item No.	24 ga Item No.
4	60	—	6EKE9	—
5	60	—	6PGC8	6PGD1
6	60	—	6EKF0	6EKF6
7	60	—	6PGC9	6PGD2
8	60	—	6EKF1	6EKF7
9	60	—	6PGD0	6PGD3
10	60	—	6EKF2	6EKF8
12	60	—	6EKF3	6EKF9
14	60	—	6EKF4	6EKG0

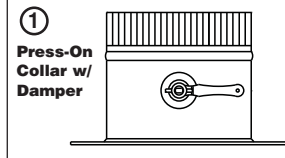

For Duct Dia. (in)	Overall Length (in)	Overall Height (in)	26 ga Item No.	24 ga Item No.
4	5	6	6EKH3	—
5	5	6	6PGD9	6PGE2
6	5	6	6EKH4	6EKJ0
7	5	6	6PGE0	6PGE3
8	5	6	6EKH5	6EKJ1
9	5	6	6PGE1	6PGE4
10	5	6	6EKH6	6EKJ2
12	5	6	6EKH7	6EKJ3
14	5	6	6EKH8	6EKJ4

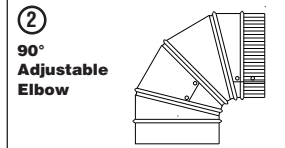

For Duct Dia. (in)	Overall Length (in)	Overall Height (in)	26 ga Item No.	24 ga Item No.
4	7	6 3/4	6EKG1	6EKG7
5	8	6 3/4	6PGD4	6PGD7
6	9	9	6EKG2	6EKG8
7	10	9	6PGD5	6PGD8
8	11	11	6EKG3	6EKG9
9	13	11	6PGD6	—
10	14	13	6EKG4	6EKH0
12	16	15	6EKG5	6EKH1
14	17 1/2	17	6EKG6	6EKH2

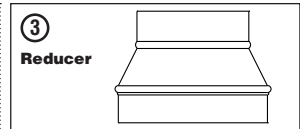

Inlet Dia. (in)	Outlet Dia. (in)	Overall Length (in)	26 ga Item No.	24 ga Item No.
5	4	6	6RFZ2	6RGA2
6	4	6	6EKK7	6EKL8
6	5	6	6RFZ3	6RGA3
7	5	6	6RFZ4	6RGA4
7	6	6	6RFZ5	6RGA5
8	4	6	6EKK8	—
8	6	6	6EKK9	6EKL9
8	7	6	6RFZ6	6RGA6
9	6	8	6RFZ7	6RGA7
9	7	6	6RFZ8	6RGA8
9	8	6	6RFZ9	6RGA9
10	6	8	6EKL0	—
10	8	8	6EKL1	6EKN0
10	9	6	6RGA0	6RGC0
12	6	10	6EKL2	—
12	8	8	6EKL3	—
12	10	6	6EKL4	6EKN1
14	8	8	6RGA1	6RGC1
14	8	8	6EKL5	—
14	10	8	6EKL6	6EKN2
14	12	6	6EKL7	6EKN3



For Duct Dia. (in)	Overall Length (in)	Overall Height (in)	26 ga Item No.	24 ga Item No.
4	5	2	6EKJ5	6EKK1
5	2	2	6PGE5	6PGE8
6	2	2	6EKJ6	6EKK2
7	2	2	6PGE6	6PGE9
8	2	2	6EKJ7	6EKK3
9	2	2	6PGE7	6RFY5
10	2	2	6EKJ8	6EKK4
12	2	2	6EKJ9	6EKK5
14	2	2	6EKK0	6EKK6

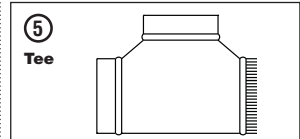

For Duct Dia. (in)	Overall Length (in)	Overall Height (in)	26 ga Item No.	24 ga Item No.
4	10 1/2	8	6EKN4	—
5	14 1/2	9	6RFY6	6RFY9
6	13	9 1/2	6EKN5	6EKP1
7	14 1/2	11	6RFY7	6RFZ0
8	15 3/4	12 1/2	6EKN6	6EKP2
9	16 3/4	13 1/2	6RFY8	6RFZ1
10	20	14 1/2	6EKN7	6EKP3
12	21 1/2	16 3/4	6EKN8	6EKP4
14	24	18 3/4	6EKN9	6EKP5

westaflex Chimney Liner Kits

- High temp.: 500°F
- Material: Aluminum
- Natural gas only

Liners are flexible and durable. Kits also include flashing, rain cap, B-vent connector, and mortar sleeve.



For Nom. Duct Dia.	Item	Overall Length	Mfr. Model	Item No.
4 in	Chimney Liner Kit	25 ft	9504	13E237
	Chimney Liner Kit	35 ft	9505	13E236
	Chimney Liners	10 ft	9505-ext	13E238
5 in	Chimney Liner Kit	25 ft	9506	13E240
	Chimney Liner Kit	35 ft	9509	13E239
	Chimney Liners	10 ft	9509-ext	13E241
6 in	Chimney Liner Kit	25 ft	9516	13E243
	Chimney Liner Kit	35 ft	9513	13E242
	Chimney Liners	10 ft	9513-ext	13E244

Chimney Liner Kits

Allow you to easily line a masonry chimney. Aluminum models are suitable for Category 1, gas-fired appliances with B-vent, or appliances with a draft hood. They include a liner, rain cap, flashing, B-vent connector, and mortar sleeve. Pull Downs 40LJ33 and 40LJ39 let you stretch and lead the flexible liner down the chimney.

For Nom. Duct Dia.	Compatible with Fuel Type	Overall Length	Max. Temp. Rating	Mfr. Model	Item No.
Chimney Liner Kits—Aluminum					
3 in	LP Gas	35 ft	470 °F	3ALK35	40LJ40
4 in	LP Gas	35 ft	470 °F	4ALK35	40LJ41
5 in	LP Gas	35 ft	470 °F	5ALK35	40LJ42
6 in	LP Gas	35 ft	470 °F	6ALK35	40LJ43
Chimney Liner Kits—Stainless Steel					
4 in	All Fuel	25 ft	1,200 °F	4MF25KT	787CE3
4 in	All Fuel	35 ft	1,200 °F	4MF35KT	787CD1
6 in	All Fuel	25 ft	1,200 °F	6MF25KT	787CD4
6 in	All Fuel	35 ft	1,200 °F	6MF35KT	787CD6
8 in	All Fuel	25 ft	1,200 °F	8MF25KT	787CD9
8 in	All Fuel	35 ft	1,200 °F	8MF35KT	787CE1
Liner Pull Down—Steel					
6 in	LP Gas	6 3/8 in	470 °F	6FX-PD	40LJ33
8 in	LP Gas	8 3/8 in	470 °F	8FX-PD	40LJ39



40LJ40