



**Master Link  
Sub Assembly**



**Swivel Latch Lock**



**Clevis Pin Latch  
Lock Slip Hook**

**Dayton**

## Grade 80 Chain Sling Components

Build chain slings to meet specific application needs and requirements. Latch lock, slip hooks, and coupling links meet ANSI/ASME B30.9 and OSHA Standards. OSHA requires ID tag on overhead chain slings.

Description	Working Load Limit	Trade Size	Finish	Item No.
Master Link Sub Assembly	9,100 lb	3/4"	Powder Coated	5WRT1 *
Swivel Latch Lock	3,500 lb	5/32 in	Powder Coated	5WRT4
Swivel Latch Lock Slip Hook	7,100 lb	3/8 in	Powder Coated	5WRT5
	12,000 lb	1/2 in	Powder Coated	5WRT6
	3,500 lb	5/32 in	Powder Coated	5WRT7
Clevis Pin Latch Lock Slip Hook	7,100 lb	3/8 in	Powder Coated	5WRT8
	12,000 lb	1/2 in	Powder Coated	5WRT9
Sling ID Tag	N/A	1/16"	Zinc-Plated	5WRU0
Sling ID Tag With Ring	N/A	1/16"	Zinc-Plated	5WRU1

\* Trade size shown is for chain used on sublinks.



**9Y241**



## Grade 100 Clevis Foundry Hooks

Steel with powder-coated finish.

Trade Size	Working Load Limit	Hook Opening	Color	Item No.
3/8 in	8,800 lb	2 3/32 in	Orange	9YFV9
1/2 in	15,000 lb	3 1/32 in	Orange	9Y241
5/8 in	22,600 lb	3 7/8 in	Red	9Y150



**13H127**



**YOKE**  
Safety is our first priority™

## Grade 100 Chain Sling Coupling Links

Alloy steel with powder-coat finish.

Working Load Limit	Trade Size	Item No.
5,700 lb	1/4 to 3/16 in	13H127
8,800 lb	3/8 in	13H128
15,000 lb	1/2 in	13H129
22,600 lb	3/4 in	13H130



**1DNH6**

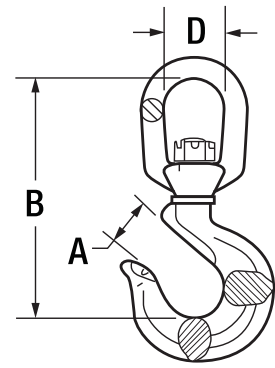

**Dayton**

## Grade 80 Swivel Hooks with Latch

Alloy steel hooks prevent wire rope and chain from twisting while lifting and aligning loads. Hooks are heat treated.

Working Load Limit	Dim. A	Dim. B	Dim. D	Item No.
2,000 lb	1 1/16"	4 3/8"	1 1/4"	1DNH6
3,000 lb	3 3/32"	5 7/16"	1 1/2"	1DNH7
4,000 lb	1 1/8"	6 1/4"	1 3/4"	1DNH8
6,000 lb	1 3/16"	6 1/2"	1 3/4"	1DNH9
10,000 lb	1 1/2"	7 1/2"	2"	1DNJ1

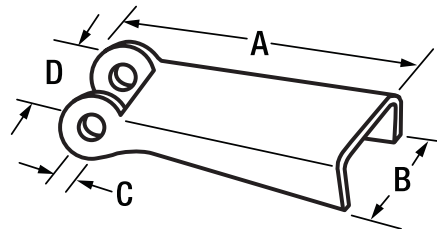

## Crosby Replacement Safety Latches

Designed to fit most hooks with a drilled pin hole. Match the distance of your hook opening to dimension A. Include mounting hardware.

C	A	B	D	Item No.	C	A	B	D	Item No.
<b>Stainless Steel</b>					<b>Steel</b>				
1 1/64 in	2 1 3/32 in	1 in	9/16 in	48FR92	5/32 in	1 1/16 in	1/2 in	1/2 in	29WR21
3/16 in	1 2 1/2 in	5 3/64 in	1 1/32 in	48FR91		1 3/16 in	1/2 in	3/64 in	29WR22
1 3/64 in	2 3 1/2 in	1 7/32 in	3 3/64 in	48FR93	1 1/64 in	1 2 1/2 in	1/2 in	1/2 in	29WR23
						1 2 1/2 in	5/8 in	2 1/2 in	29WR24
					1 1/64 in	2 5/16 in	5/8 in	5/64 in	29WR25
					1 1/64 in	2 7/8 in	1 1/8 in	1 3/64 in	29WR26
					1 1/64 in	3 3/16 in	1 3/64 in	1 1/4 in	29WR27
					1 1/64 in	3 1 1/16 in	1 9/64 in	1 2 3/64 in	29WR28
					2 5/64 in	5 5/32 in	1 1/2 in	1 2 1/2 in	29WR29